

Steeline "S-Series" Single Door Aluminum Type 4X Wallmount Enclosure

Material:

Type 5052 H-32 aluminum
Seams continuously welded and ground smooth
External screw clamps are quick and easy to operate
Stainless Steel door clamp assemblies
External mounting feet
Form in place gasket

Finish:

Housing and door is Aluminum
Exterior/Interior surface are unfinished, door front to be smooth brush finish
Mounting Panel optional

Protection Ratings:

UL / cUL Type 12, 13, 4, & 4X
UL File Number E158158
IEC 60529, IP65

Configuration:

Single door Type 4X
Pad lock hasp
Mounting Panel
Door—left hand hinge
External clamps—Type 4X

Detail Drawings:

www.steelineenclosures.com

Accessories:

Optional MPL (Carbon Steel or Aluminum)
Climate Control options (Fans and Louvers or A/C)
Dead Front Kits
Leg Stand Kits
Lighting Kits

Modification Service:

Optional modifications per customer specification

Part Number System
S— Steeline Wallmount Enclosure
121206— H"xW"xD" of Enclosure
AL— Aluminum

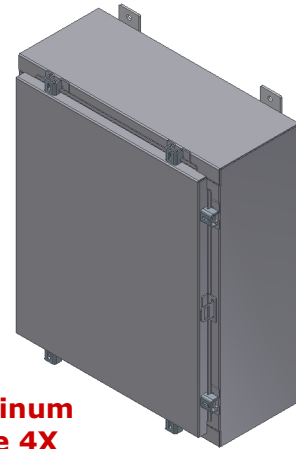

**Aluminum
Type 4X**

Part Number	H (in)	W (in)	D (in)	Mounting Panel Part Number	MPL H (in)	MPL W (in)
6" Depth						
S161206NFAL	16	12	6	S-16P12AL	13"	9"
S201606NFAL	20	16	6	S-20P16AL	17"	13"
S202006NFAL	20	20	6	S-20P20AL	17"	17"
S242006NFAL	24	20	6	S-24P20AL	17"	21"
S242406NFAL	24	24	6	S-24P24AL	21"	21"
8" Depth						
S161608NFAL	20	16	8	S-20P16AL	21"	13"
S202008NFAL	20	20	8	S-20P20AL	17"	17"
S242408NFAL	24	24	8	S-24P24AL	21"	21"
S302408NFAL	30	24	8	S-30P24AL	27"	21"
S303008NFAL	30	30	8	S-30P30AL	27"	27"
S362408NFAL	36	24	8	S-36P24AL	33"	21"
S363008NFAL	36	30	8	S-36P30AL	33"	27"
S483608NFAL	48	36	8	S-48P36AL	45"	33"
10" Depth						
S201610NFAL	20	16	10	S-20P16AL	17"	13"
S242010NFAL	24	20	10	S-24P20AL	21"	17"
12" Depth						
S302412NFAL	30	24	12	S-30P24AL	27"	21"
S363012NFAL	36	30	12	S-36P30AL	33"	27"
S483612NFAL	48	36	12	S-48P36AL	45"	33"
S603612NFAL	60	36	12	S-60P36AL	57"	33"

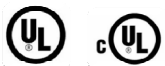

Steeline "S-Series" Single Door Aluminum Type 4X Wallmount Enclosure

Front View

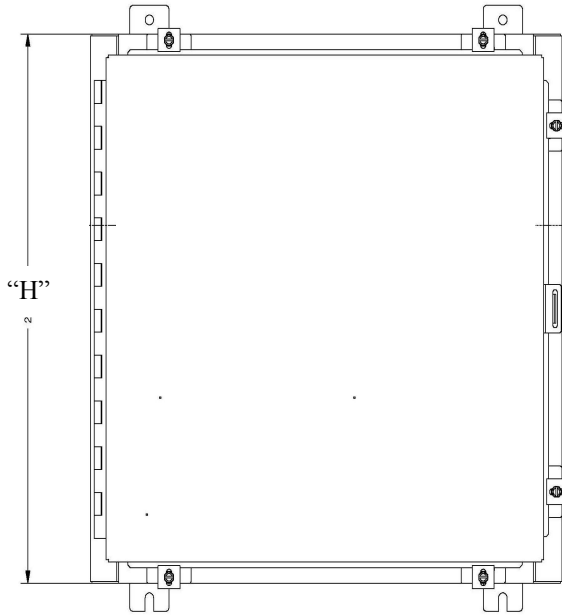

Side View

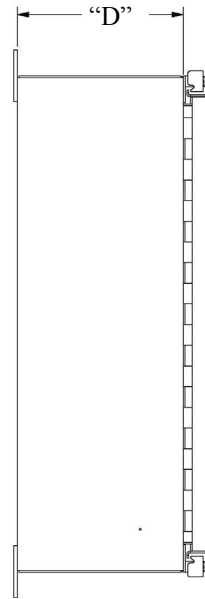

Top View

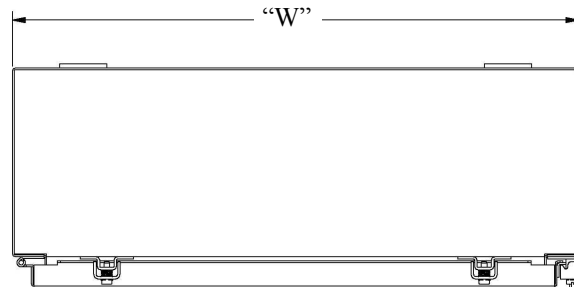

-Continue-