

Steeline "SW" Series Single and Double Door Type 4 & 4X Wallmount Enclosure (Quarter Turn Latch)



Material:

Sheet Steel or Stainless Steel 14-16 gauge
12"H x 12"W - 24"H x 20"W 16ga. Body / 16ga. Door
24"H x 24"W - 36"H x 24"W 16ga. Body / 14ga. Door
36"H x 30"W - 42"H x 32"W 14ga. Body / 14ga. Door

Finish:

Housing and door are Carbon Steel, 304 / 316L Stainless Steel
ANSI 61 Gray powder paint (smooth or textured) or #4 brushed finish
Mounting Panel (optional)

Protection Ratings:

UL / cUL Type 12, 13, 4, and 4X
UL File Number: E158158
IEC 60529, IP66
Type 12 2-Door - IP 55

Configuration:

Single door UL Type 4
(UL Type 4X Stainless Steel only)
Mounting Panel 12ga
Double door UL type 12
Door left hand hinge to open 180 degrees
Quarter turn latch insert are flush slotted inserts
Single door enclosure less than 20" high has one ¼ Turn Latch
Single door enclosure 20" - 36" high have two ¼ Turn Latch
Single door enclosure greater than or equal to 36" to have single handle three point latch
Double door enclosure greater than or equal to 36" to have single handle three point latch
Bolt on Wall mount Tabs (Kit)

Detail Drawings:

www.steelenclosures.com

Accessories:

Optional MPL (Carbon Steel, Stainless Steel, or Aluminum)
Wall mount Brackets—**SWMB, SWMBSS6, SWFKS, or SWFKSS6S**
*reference last page of this specification Sheet.
Window Kits
Climate Control options (Fans and Louvers or A/C)
Dead Front Kits
Leg Stand Kits
Lighting Kits

Modification Service:

Optional modifications per customer specification

Part Number System

SW— Steeline Wallmount Enclosure
121206— H"xW"x"D" of Enclosure
D— Disconnect
C, SS4, SS6—Material
2Dr—# of Doors

Part Number	H (in)	W (in)	D (in)	Mounting Panel Part Number	MPL H(in)	MPL W(in)
-------------	--------	--------	--------	----------------------------	-----------	-----------

Carbon Steel						
6" Depth						
SW121206C	12	12	6	SWP1212	10.2	10.2
SW161206C	16	12	6	SWP1612	14.2	10.2
SW161406C	16	14	6	SWP1614	14.2	12.2
SW162006C	16	20	6	SWP1620	14.2	18.2
SW201606C	20	16	6	SWP2016	18.2	14.2
SW202006C	20	20	6	SWP2020	18.2	18.2
SW241606C	24	16	6	SWP2416	22.2	14.2
SW242006C	24	20	6	SWP2420	22.2	18.2
SW242406C	24	24	6	SWP2424	22.2	22.2
SW302406C	30	24	6	SWP3024	28.2	22.2
8" Depth						
SW161208C	16	12	8	SWP1612	14.2	10.2
SW161608C	16	16	8	SWP1616	14.2	14.2
SW162008C	16	20	8	SWP1620	14.2	18.2
SW201608C	20	16	8	SWP2016	18.2	14.2
SW202008C	20	20	8	SWP2020	18.2	18.2
SW202408C	20	24	8	SWP2024	18.2	22.2
SW241608C	24	16	8	SWP2416	22.2	14.2
SW242008C	24	20	8	SWP2420	22.2	18.2
SW242408C	24	24	8	SWP2424	22.2	22.2
SW242608CD	24	26	8	SWP2426	22.2	24.2
SW243008C	24	30	8	SWP2430	22.2	28.2
SW244208C	24	42	8	SWP2442	22.2	40.2
SW302008C	30	20	8	SWP3020	28.2	18.2
SW302408C	30	24	8	SWP3024	28.2	22.2
SW303008C	30	30	8	SWP3030	28.2	28.2
SW362408C	36	24	8	SWP3624	34.2	22.2



-Continue-



Steeline "SW" Series Single and Double Door Type 4 & 4X Wallmount Enclosure (Quarter Turn Latch)

Part Number H (in) W (in) D (in) Mounting Panel Part Number MPL H(in) MPL W(in)

Carbon Steel

8" Depth						
SW363008C	36	30	8	SWP3630	34.2	28.2
SW364208CD	36	32	8	SWP3632	34.2	30.2
SW363608C	36	36	8	SWP3636	34.2	34.2
SW423008C	42	30	8	SWP4230	40.2	28.2
SW423608C	42	36	8	SWP4236	40.2	34.2
SW483608C	48	36	8	SWP4836	46.2	34.2
10" Depth						
SW242010C	24	20	10	SWP2420	22.2	18.2
SW242410C	24	24	10	SWP2424	22.2	22.2
SW302410C	30	24	10	SWP3024	28.2	22.2
SW304210C	30	42	10	SWP3042	28.2	40.2
SW304810C	30	48	10	SWP3048	28.2	46.2
SW362410C	36	24	10	SWP3624	34.2	22.2
SW363010C	36	30	10	SWP3630	34.2	28.2
SW363210CD	36	32	10	SWP3632	34.2	28.2
SW423610C	42	36	10	SWP4236	40.2	34.2
SW483610C	48	36	10	SWP4836	46.2	34.2
SW603610C	60	36	10	SWP6036	58.2	34.2
SW603810CD	60	38	10	SWP6038	58.2	34.2
12" Depth						
SW202012C	20	20	12	SWP2020	18.2	18.2
SW242012C	24	20	12	SWP2420	22.2	18.2
SW242412C	24	24	12	SWP2424	22.2	22.2
SW302412C	30	24	12	SWP3024	28.2	22.2
SW303012C	30	30	12	SWP3030	28.2	28.2
SW362412C	36	24	12	SWP3624	34.2	22.2
SW363012C	36	30	12	SWP3630	34.2	28.2
SW363212CD	36	32	12	SWP3632	34.2	28.2
SW363612C	36	36	12	SWP3636	34.2	34.2
SW364212C	36	42	12	SWP3642	34.2	40.2
SW364812C	36	48	12	SWP3648	34.2	46.2
SW366012C	36	60	12	SWP3660	34.2	58.2
SW423212CD	42	32	12	SWP4232	40.2	28.2
SW423612C	42	36	12	SWP4236	40.2	34.2

Part Number H (in) W (in) D (in) Mounting Panel Part Number MPL H(in) MPL W(in)

Carbon Steel

12" Depth						
SW426012C	42	60	12	SWP4260	40.2	58.2
SW483612C	48	36	12	SWP4836	46.2	34.2
SW483812CD	48	38	12	SWP4838	46.2	36.2
SW484812C	48	48	12	SWP4848	46.2	46.2
SW603612C	60	36	12	SWP6036	58.2	34.2
SW603812CD	60	38	12	SWP6038	58.2	36.2
SW723612C	72	36	12	SWP7236	70.2	34.2
16" Depth						
SW363016C	36	30	16	SWP3630	34.2	28.2
SW483616C	48	36	16	SWP4836	46.2	34.2
SW483816CD	48	38	16	SWP4838	46.2	36.2
SW603616C	60	36	16	SWP6036	58.2	34.2
20" Depth						
SW302420C	30	24	20	SWP3024	28.2	22.2
SW483620C	48	36	20	SWP4836	46.2	34.2

-Continue-



Steeline "SW" Series Single and Double Door Type 4 & 4X Wallmount Enclosure (Quarter Turn Latch)

Part Number	H (in)	W (in)	D (in)	Mounting Panel Part Number	MPL H (in)	MPL W (in)
Stainless Steel 304						
6" Depth						
SW121206SS4	12	12	6	SWP1212	10.2	10.2
SW161206SS4	16	12	6	SWP1612	14.2	10.2
SW161606SS4	16	16	6	SWP1616	14.2	14.2
SW201606SS4	20	16	6	SWP2016	18.2	14.2
SW202006SS4	20	20	6	SWP2020	18.2	18.2
8" Depth						
SW161208SS4	16	12	8	SWP1612	14.2	10.2
SW201608SS4	20	16	8	SWP2016	18.2	14.2
SW202008SS4	20	20	8	SWP2020	18.2	18.2
SW241608SS4	24	16	8	SWP2416	22.2	14.2
SW242008SS4	24	20	8	SWP2420	22.2	18.2
SW242408SS4	24	24	8	SWP2424	22.2	22.2
SW302408SS4	30	24	8	SWP3024	28.2	22.2
SW303008SS4	30	30	8	SWP3030	28.2	28.2
SW362408SS4	36	24	8	SWP3624	34.2	22.2
SW363008SS4	36	30	8	SWP3630	34.2	28.2
10" Depth						
SW242010SS4	24	20	10	SWP2420	22.2	22.2
SW302410SS4	30	24	10	SWP3024	28.2	22.2
SW363010SS4	36	30	10	SWP3630	34.2	28.2
SW483610SS4	48	36	10	SWP4836	46.2	34.2
12" Depth						
SW242412SS4	24	24	12	SWP2424	22.2	22.2
SW302412SS4	30	24	12	SWP3024	28.2	22.2
SW363012SS4	36	30	12	SWP3630	34.2	28.2
SW363612SS4	36	36	12	SWP3636	34.2	34.2
SW423612SS4	42	36	12	SWP4236	40.2	34.2
SW483612SS4	48	36	12	SWP4836	46.2	34.2
SW603612SS4	60	36	12	SWP6036	58.2	34.2
16" Depth						
SW363016SS4	36	30	16	SWP3630	34.2	28.2
SW483616SS4	48	36	16	SWP4836	46.2	34.2
SW603616SS4	60	36	16	SWP6036	58.2	34.2

Part Number	H (in)	W (in)	D (in)	Mounting Panel Part Number	MPL H (in)	MPL W (in)
Stainless Steel 316L						
6" Depth						
SW121206SS6	12	12	6	SWP1212	10.2	10.2
SW161206SS6	16	12	6	SWP1612	14.2	10.2
SW161606SS6	16	16	6	SWP1616	14.2	14.2
SW201606SS6	20	16	6	SWP2016	18.2	14.2
SW202006SS6	20	20	6	SWP2020	18.2	18.2
8" Depth						
SW161208SS6	16	12	8	SWP1612	14.2	10.2
SW201608SS6	20	16	8	SWP2016	18.2	14.2
SW202008SS6	20	20	8	SWP2020	18.2	18.2
SW241608SS6	24	16	8	SWP2416	22.2	14.2
SW242008SS6	24	20	8	SWP2420	22.2	18.2
SW242408SS6	24	24	8	SWP2424	22.2	22.2
SW302408SS6	30	24	8	SWP3024	28.2	22.2
SW303008SS6	30	30	8	SWP3030	28.2	28.2
SW362408SS6	36	24	8	SWP3624	34.2	22.2
SW363008SS6	36	30	8	SWP3630	34.2	28.2
10" Depth						
SW242010SS6	24	20	10	SWP2420	22.2	22.2
SW302410SS6	30	24	10	SWP3024	28.2	22.2
SW363010SS6	36	30	10	SWP3630	34.2	28.2
SW483610SS6	48	36	10	SWP4836	46.2	34.2
12" Depth						
SW242412SS6	24	24	12	SWP2424	22.2	22.2
SW302412SS6	30	24	12	SWP3024	28.2	22.2
SW363012SS6	36	30	12	SWP3630	34.2	28.2
SW363612SS6	36	36	12	SWP3636	34.2	34.2
SW423612SS6	42	36	12	SWP4236	40.2	34.2
SW483612SS6	48	36	12	SWP4836	46.2	34.2
SW603612SS6	60	36	12	SWP6036	58.2	34.2
16" Depth						
SW363016SS6	36	30	16	SWP3630	34.2	28.2
SW483616SS6	48	36	16	SWP4836	46.2	34.2
SW603616SS6	60	36	16	SWP6036	58.2	34.2

Steeline "SW" Series Single and Double Door Type 4 & 4X Wallmount Enclosure (Quarter Turn Latch)



**SW—Wall Mount Enclosure without
bolt on wall brackets.**



**SW—Wall Mount Enclosure with
bolt on wall brackets**

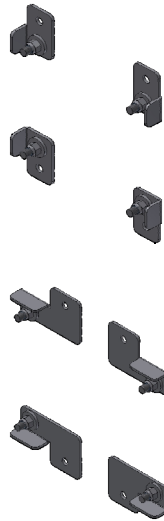

**With bolt on Wall mount tabs
Part Numbers:**

SWFK-S—Maintain enclosure (Straight) hole pattern, Mild Steel painted same color as enclosure.

SWSKSS6-S—Maintain enclosure (Straight) hole pattern, 316L Stainless Steel.

**With bolt on Wall mount tabs
Part Numbers:**

SWFK—Maintain enclosure (NEMA) hole pattern, Mild Steel painted same color as enclosure.

SWFKSS6—Maintain enclosure (NEMA) hole pattern, 316L Stainless Steel.

- Optional Weld in Place NEMA Type Wall Mount Brackets:
- Please consult factory for availability.

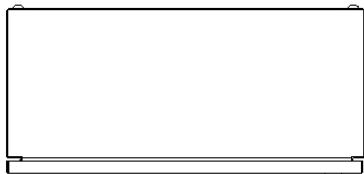

Front View

Side View

